

\$375,000 - 5116 50 Avenue, Sylvan Lake

MLS® #A2166392

\$375,000

0 Bedroom, 0.00 Bathroom,
Land on 0.26 Acres

Downtown, Sylvan Lake, Alberta

Prime development property jus a few blocks to the Lake and Downtown. This 100' x 126' (11,450 Sq Ft)property is zoned Water Front Direct Control and would be perfect for 4 Townhouse units, a fourplex or an apartment building. There is a 1930s era 2 story home with no water or sewer with little or no value and 3 outbuildings. There may be some salvage potential of the hardwood floors, windows and siding. This property has been rezoned to Heritage Direct Control District, refer to the Sylvan Lake Land Use Bylaws.

Essential Information

| | |
|-----------|------------------|
| MLS® # | A2166392 |
| Price | \$375,000 |
| Bathrooms | 0.00 |
| Acres | 0.26 |
| Type | Land |
| Sub-Type | Residential Land |
| Status | Active |

Community Information

| | |
|-------------|-----------------|
| Address | 5116 50 Avenue |
| Subdivision | Downtown |
| City | Sylvan Lake |
| County | Red Deer County |
| Province | Alberta |
| Postal Code | T4S 1E6 |

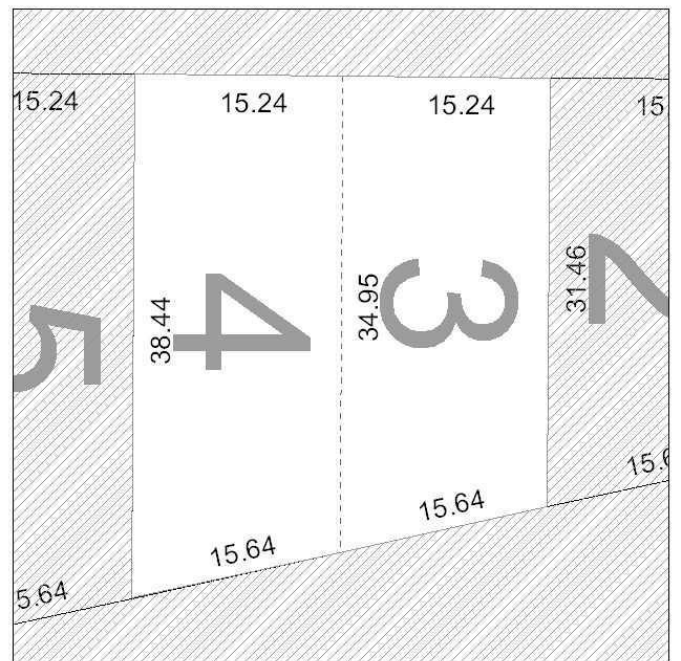

Amenities

Utilities Cable Available, Electricity at Lot Line

Exterior

Lot Description Back Lane, Level

Additional Information

Date Listed September 16th, 2024
Days on Market 222
Zoning Heritage Direct Control D

Listing Details

Listing Office RE/MAX real estate central alberta

Data is supplied by Pillar 9â„¢ MLSÂ® System. Pillar 9â„¢ is the owner of the copyright in its MLSÂ® System. Data is deemed reliable but is not guaranteed accurate by Pillar 9â„¢. The trademarks MLSÂ®, Multiple Listing ServiceÂ® and the associated logos are owned by The Canadian Real Estate Association (CREA) and identify the quality of services provided by real estate professionals who are members of CREA. Used under license.