

# \$325,000 - 7952 Creekside Drive, Rural Grande Prairie No. 1, County of

MLS® #A2048918

**\$325,000**

0 Bedroom, 0.00 Bathroom,  
Land on 0.85 Acres

Taylor Estates, Rural Grande Prairie No. 1,  
County of, Alberta

Taylor Estates, the most sought after address in the Peace; Taylor Estates affords you all of the convenience of city living and all the comfort of country life in this well-planned community. On the Southwest edge of the city, in the County of Grande Prairie, large rural estate properties are situated on the banks of Bear Creek. Choose your lot, choose your builder, and get started on your Dream Home in Taylor Estates.

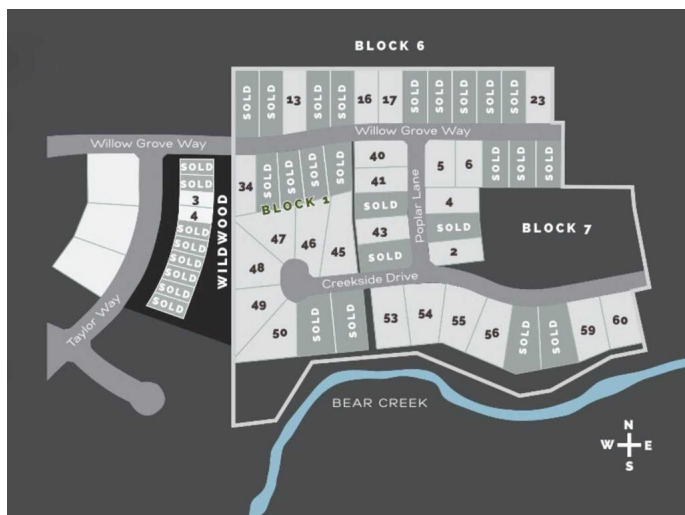

## Essential Information

|           |                  |
|-----------|------------------|
| MLS® #    | A2048918         |
| Price     | \$325,000        |
| Bathrooms | 0.00             |
| Acres     | 0.85             |
| Type      | Land             |
| Sub-Type  | Residential Land |
| Status    | Active           |

## Community Information

|             |                                 |
|-------------|---------------------------------|
| Address     | 7952 Creekside Drive            |
| Subdivision | Taylor Estates                  |
| City        | Rural Grande Prairie No. 1, C   |
| County      | Grande Prairie No. 1, County of |
| Province    | Alberta                         |
| Postal Code | T8W 0H3                         |



## Amenities

Utilities Cable Available, Electricity Available, Natural Gas Available, Phone Available

## Additional Information

Date Listed May 23rd, 2023

Days on Market 703

Zoning RE

## Listing Details

Listing Office RE/MAX Grande Prairie

Data is supplied by Pillar 9â„¢ MLSÂ® System. Pillar 9â„¢ is the owner of the copyright in its MLSÂ® System. Data is deemed reliable but is not guaranteed accurate by Pillar 9â„¢. The trademarks MLSÂ®, Multiple Listing ServiceÂ® and the associated logos are owned by The Canadian Real Estate Association (CREA) and identify the quality of services provided by real estate professionals who are members of CREA. Used under license.